

# 0740 Patriot High Security and 0780 Patriot Midi Flag Hinges

## Adjustment Instructions



### 1 – OPENING FLAG

**Note: Diagrams of flag show hinge not fitted. When the hinge is fitted, access the cover latch from between the sash and frame with the door open**

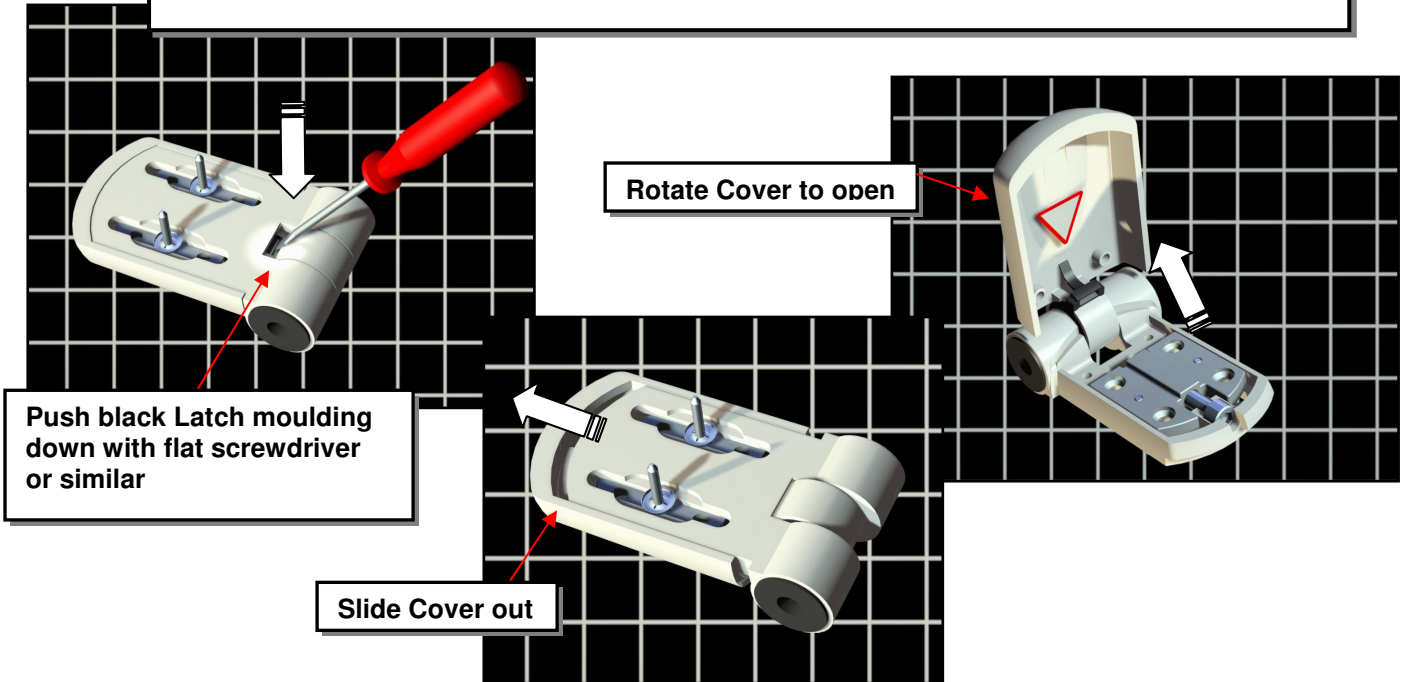

### 2 - ADJUSTMENT

**Note: It is recommended that 3 hinges be fitted per door leaf. It is important that accurate adjustment is made so that each hinge takes equal weight and gives equal compression**

